

ASSEMBLY INSTRUCTION FOR CLAMPING RINGS

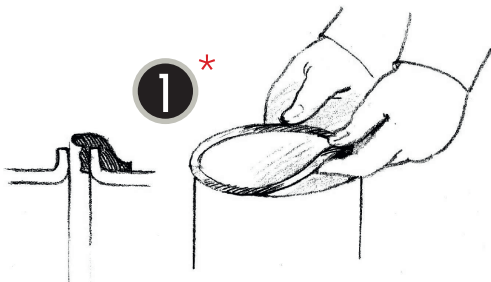

Select the seal ring according to the pipe diameter and pull it onto one of the lips. Start at the seam. The profiled side of the seal ring must face the connecting pipe. The seal ring may be drawn a little when pulling on.

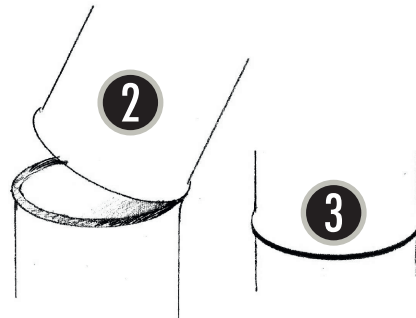

Place the connecting pipe evenly aligned onto the pipe with the fitted seal ring and check the fit.

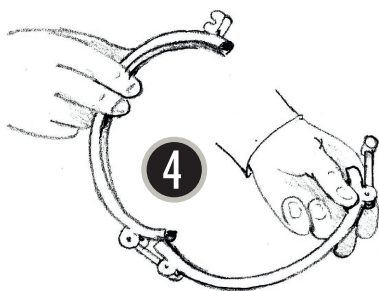

Loosen both clamping screws, but do not completely unscrew from the tension anchors. One of the tension anchors is galvanized yellow or, in the stainless steel version, has a groove. Unhook this tension anchor.

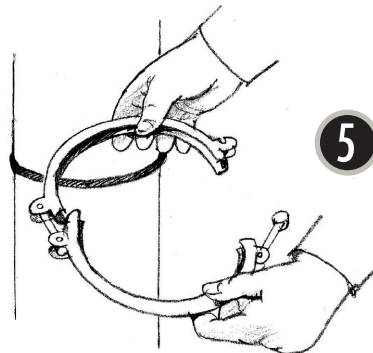

Open the clamping ring by rotating at the tension anchor. The entire clamping ring remains together as a unit including the screws.

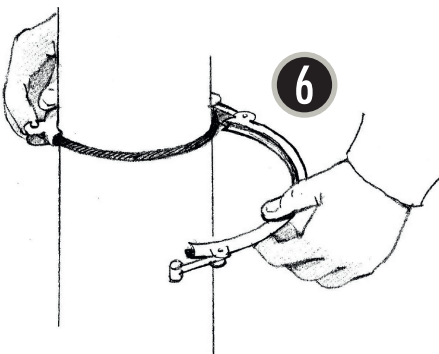

Place the clamping ring around the pipe parts and hook in the tension anchor.

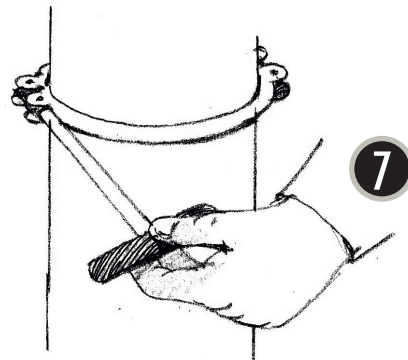

Finally, tighten both screws evenly with a torque of 10 Nm.

* Step 1 is omitted when mounting „clamping rings with seal insert“.

The foil must be removed from the sealing compound before using the clamping ring with seal insert.